

Instructions

Questions and answers

- You have **25 minutes** to complete this paper.
 - Read each question carefully.
 - Do exactly what the instructions say.
 - Make sure your answers are carefully written and easily understood.
-

Marks

- The number of marks in the margin tells you the maximum number of marks for that part of the question.
- You should work through the paper until you are asked to stop.
- Work as quickly and as carefully as you can. If you finish before the end, **go back and check your work.**

I. What plants need

a.

Anne knows that plants need water to grow. She grows some plants and investigates whether the amount of water affects their growth.



What should Anne do to carry out her experiment in the best way? Tick **yes** or **no** for each question.

| | Yes | No |
|--|-----|----|
| Should Anne use the same soil for each plant? | | |
| Should Anne use the same amount of water for each plant? | | |
| Should Anne grow the plants in the same place? | | |

Marks

1

b.

Anne also knows that plants absorb water from the soil.

Write down the names of **two** parts of the plant that water must travel through to get from the soil to the leaves.

1. _____

2. _____

1

C.

Decide whether each of these items is a raw material or whether it has been changed or manufactured. Write **R** in the box if you think it is a raw material, or write **C** in the box if you think it has been changed or manufactured.

Marks









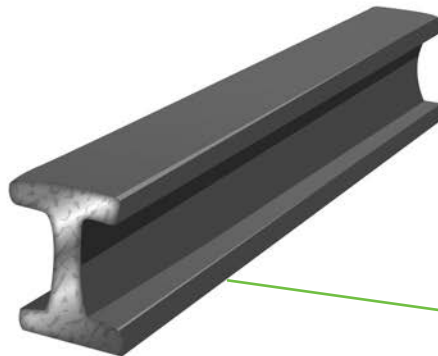

2

4. Resistance and friction

Marks

a.

Martin puts a large piece of modelling clay in Boat A and a smaller piece in Boat B.



Martin fills a sink with water. He puts the boats in the water so that they float.

What do you see happening?



1

b.

Explain why this is happening.



1